

Weld on Caps

Schedule 40, 316 Stainless Steel

Inches / Pounds

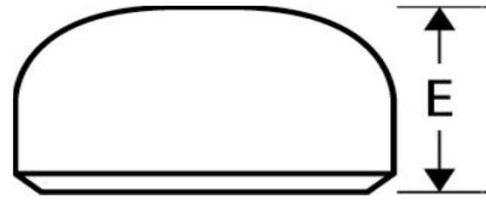

Part #	Nominal Pipe Size	Outside Diameter	Inside Diameter	Wall Thickness	Length (E)	Pipe Schedule	Approximate Weight (in Lbs.)
K40C.5SS	1/2	0.84	0.622	0.109	1.00	40	0.07
K40C.75SS	3/4	1.05	0.824	0.113	1.00	40	0.1
K40C1SS	1	1.32	1.049	0.133	1.50	40	0.2
K40C1.25SS	1 1/4	1.66	1.380	0.140	1.50	40	0.3
K40C1.5SS	1 1/2	1.90	1.610	0.145	1.50	40	0.3
K40C2SS	2	2.38	2.067	0.154	1.50	40	0.5
K40C2.5SS	2 1/2	2.88	2.469	0.203	1.50	40	0.8
K40C3SS	3	3.50	3.068	0.216	2.00	40	1.4
K40C4SS	4	4.50	4.026	0.237	2.50	40	2.5
K40C5SS	5	5.56	5.047	0.258	3.00	40	4.1
K40C6SS	6	6.62	6.065	0.280	3.50	40	6.4
K40C8SS	8	8.62	7.981	0.322	4.00	40	11.3

* Dimensions conform to ASME B16.9 & MSS SP-43

* Material conforms to ASTM A430 Grade 316/316L